

CRP Clutch-Roto Sheave® Units

[BACK TO TABLE OF CONTENTS](#)
[BACK TO CLUTCH OVERVIEW](#)

- CSA certified.
- Pre-aligned, one-piece package can be mounted almost anywhere: line shaft, motor shaft, or stub shaft.
- Mounts in any position without special modifications.
- Spring release for positive disengagement.
- Precision sealed ball bearings for long trouble-free life.
- Zinc plated magnet body for corrosion resistance.
- Epoxy encapsulated coil construction for uniform heat transfer and moisture resistance.
- Class H magnet wire and potting material.

Installation and Service Instructions Sheet 8-078-800-02 and Parts List Sheets:
 8-078-802-01 (Size 3.5) 8-078-802-02 (Size 5)
 8-078-802-03 (Size 5.5) 8-078-802-04 (Size 8)

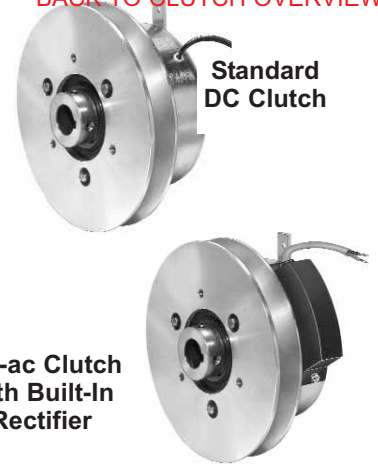

Size 3.5 and 5

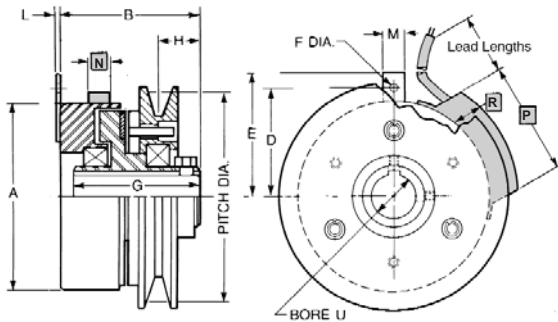

Dimensions are for estimating only and subject to change without notice.
 For installation purposes, request certified prints.

Size 5.5 and 8

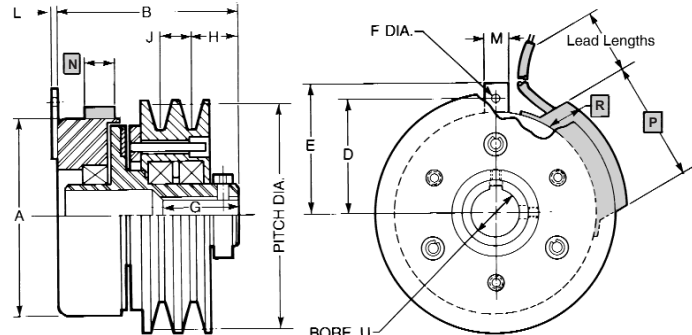

Lead Lengths: All Tor-ac units have 32" leads.
 Standard DC unit has 24" leads.

Dimensional Data (In Inches)

Size	A	B	D	E	F	G	H	J	L	M	N	P	R	U Bore
3.5	3.19	2.75	1.81	2.00	.19	2.50	.86	—	.06	.66	1.00	2.74	.80	3/8, 1/2, 5/8
5	4.31	3.10	2.50	2.84	.19	1.35	.89	—	.09	.50	1.00	2.81	.69	1/2, 5/8, 3/4, 7/8, 1
5.5	5.63	4.38	3.25	3.50	.25	2.49	.94	.75	.09	.75	1.00	2.93	.81	3/4, 7/8, 1, 1 1/8, 1 1/4
8	8.38	4.81	4.63	5.00	.34	4.56	1.00	.75	.13	1.00	—	—	—	1 1/8, 1 1/4, 1 3/8, 1 1/2, 1 5/8, 1 3/4

IMPORTANT NOTE:
 Information and dimensioning relating to Tor-ac units shown in shaded area.

Performance/List Price Data (Discount Symbol X-1)

Catalog Number	Size	Part Number	Nominal Static Torque (lb-in)	Nominal Dynamic Torque at 1800 RPM (lb-in)	Max. RPM	Drive Hub Inertia (lb-ft ²)	Thermal Capacity (ft-lb/min) ^①	Approx. Weight (lbs)	Maximum Electrical Power (watts)	List Price ^②
CRP-35P	3.5	2-11-3161-00	100	65	5000	.00317	2750	4	11	\$ 2172.00
CRP-35PT	3.5	2-11-3181-00	100	65	5000	.00317	2750	4	11	2356.00
CRP-50P	5	2-11-4268-00	275	160	5000	.0164	4400	6	15	2584.00
CRP-50PT	5	2-11-4281-00	275	160	5000	.0164	4400	6	15	2644.00
CRP-55P	5.5	2-11-5522-02	720	400	3600	.0689	8250	12 3/4	26	3880.00
CRP-55PT	5.5	2-11-5581-00	720	400	3600	.0689	8250	12 3/4	26	4064.00
CRP-80P	8	2-11-8321-01	1740	1160	1800	.6640	16500	34	35	7160.00

①Thermal capacity rating is based on ambient temperature of 70°F at 1750 RPM.

②List prices subject to change without notice. List price is the same for unit with or without sheave.

Ordering Information

Example of a complete part number:

2-11-3161-00-J J A — 3.6A-4.0B section sheave
 — 90-100 Vdc
 — 1/2 bore 1/8 x 1/16 keyway

Voltage Table

Character	Voltage
C	12 Vdc
E	24-28 Vdc
J	90-100 Vdc
N*	115 Vac*

*Includes rectifier. Not available on size 8.

Bore and Keyway Table*

Character	H	J	L	N	O	Q	R	T	U	V	X	Y
Bore/Shaft Dia. (in.)	3/8	1/2	5/8	3/4	7/8	1	1 1/8	1 1/4	1 3/8	1 1/2	1 5/8	1 3/4
Keyway (inches)	3/32 3/64	1/8 1/16	3/16 3/32	3/16 3/32	3/16 3/32	1/4 1/8	1/4 1/8	1/4 1/8	5/16 5/32	3/8 3/16	3/8 3/16	3/8 3/16

*Special or metric bores available, consult factory.

Sheave Table

Clutch Size	3.5			5			5.5			8			ALL
Character	A	B	C	D	E	F	K	L	M	A	B	C	W
Pitch Dia. (in.)	A	3.6	3.8	4.2	4.4	4.8	5.0	5.2	5.4	5.8	7.0	8.2	9.0
	B	4.0	4.2	4.6	4.8	5.2	5.4	5.6	5.8	6.2	7.4	8.6	9.4
Number of Grooves	1	1	1	1	1	1	2	2	2	2	2	2	without sheave