

# CCC Clutch-Clutch Coupling

- CSA certified
- Ball-bearing mounted stationary field for long trouble-free operation
- Spline drive for long life under heavy loads
- Available with spring release
- Available with case hardened armature
- Zinc plated magnet body for corrosion resistance
- Epoxy encapsulated coil construction for uniform heat transfer and moisture resistance
- Class H magnet wire and potting material

Installation and Service Instructions Sheet 8-078-800-00



Standard DC Clutch



Tor-ac Clutch with Built-In Rectifier

Dimensions are for estimating only and subject to change without notice. For installation purposes, request certified prints.

**IMPORTANT NOTE:**  
Information and dimensioning relating to Tor-ac units shown in shaded area.

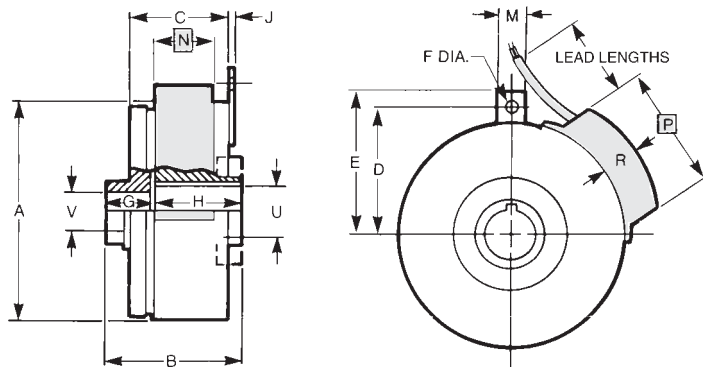

## Dimensional Data (In Inches)

Size	A	B	C	D	E	F	G	H	J	M	N	P	R	U Bore (Drive Hub)	V Bore (Driven Hub)
3	2.67	2.04	1.40	1.56	1.75	.13	.63	1.35	.06	.50	—	—	—	1/4, 5/16, 3/8	1/4, 5/16, 3/8
3.5	3.19	2.14	1.49	1.81	2.00	.19	.63	1.44	.06	.66	1.00	2.74	.80	3/8, 1/2, 5/8	3/8, 1/2, 5/8, 3/4
5	4.31	2.66	1.78	2.50	2.84	.19	.81	1.71	.09	.50	1.00	2.81	.69	1/2, 5/8, 3/4, 7/8, 1	1/2, 5/8, 3/4, 7/8, 1
5.5	5.63	3.45	2.20	3.25	3.50	.25	1.16	2.17	.09	.75	1.00	2.93	.81	3/4, 7/8, 1, 1 1/8, 1 1/4	3/4, 7/8, 1, 1 1/8, 1 1/4
8	8.38	3.39	2.38	4.63	5.00	.34	1.50	1.50	.13	1.00	—	—	—	5/8, 7/8, 1, 1 1/4, 1 1/2, 1 5/8**	5/8, 7/8, 1, 1 1/4, 1 1/2, 1 5/8**

Lead Lengths: All Tor-ac units have 32" leads. Standard DC unit, sizes 3 through 5 have 18" leads. Sizes 5.5 and 8 have 24" leads\*

\*Sizes 5.5 and 8 have cable grip fitting and 2 conductor cable. \*\*Size 8 has taper lock bushings.

## Performance/List Price Data (Discount Symbol X-1)

Catalog Number	Size	Type	Part Number	Nominal Static Torque (lb-in)	Nominal Dynamic Torque at 1800 RPM (lb-in)	Max. RPM	Inertia		Thermal Capacity (ft-lb/min) <sup>①</sup>	Approx. Weight (lbs)	Max Power (watts)	List Price
							Driven Side (lb-ft <sup>2</sup> )	Drive Side (lb-ft <sup>2</sup> )				
CCC-30	3	standard	2-11-2502-00	60	40	7000	24 x 10 <sup>-4</sup>	1.67 x 10 <sup>-3</sup>	1650	2.5	9	\$1068.00
CCC-30S		spring rel.	2-11-2502-01									
CCC-35	3.5	standard	2-11-3141-00	100	65	5000	47 x 10 <sup>-4</sup>	2.96 x 10 <sup>-3</sup>	2750	3.5	11	1380.00
CCC-35S		spring rel.	2-11-3141-01									
CCC-35T	3.5	standard	2-11-3170-00	100	65	5000	47 x 10 <sup>-4</sup>	2.96 x 10 <sup>-3</sup>	2750	3.5	11	1564.00
CCC-35ST		spring rel.	2-11-3170-01									
CCC-50	5	standard	2-11-4266-00	275	160	5000	57 x 10 <sup>-4</sup>	1.47 x 10 <sup>-2</sup>	4400	5.4	14	1500.00
CCC-50S		spring rel.	2-11-4266-01									
CCC-50T	5	standard	2-11-4270-00	275	160	5000	57 x 10 <sup>-4</sup>	1.47 x 10 <sup>-2</sup>	4400	5.4	14	1686.00
CCC-50ST		spring rel.	2-11-4270-01									
CCC-55	5.5	standard	2-11-5501-01	720	400	3600	57 x 10 <sup>-3</sup>	6.09 x 10 <sup>-2</sup>	8250	12	26	2116.00
CCC-55S		spring rel.	2-11-5501-04									
CCC-55T	5.5	standard	2-11-5570-00	720	400	3600	57 x 10 <sup>-3</sup>	6.09 x 10 <sup>-2</sup>	8250	12	26	2302.00
CCC-55ST		spring rel.	2-11-5570-01									
CCC-80	8	standard	2-11-8333-01	1740	1160	3600	59 x 10 <sup>-2</sup>	46.2 x 10 <sup>-2</sup>	16500	32	35	3310.00
CCC-80S		spring rel.	2-11-8301-01									

① Thermal capacity rating is based on ambient temperature of 70°F at 1750 RPM.

List prices subject to change without notice.

## Ordering Information

Example of a complete part number:

2-11-2502-00-H J N — 3/4 bore 3/16 x 3/32 keyway  
 — 90-100 Vdc  
 — 3/8 bore 3/32 x 3/64 keyway

### Bore and Keyway Table\*

Character	Sizes 3, 3.5, 5, 5.5											Size 8 (bushings)									
	D	F	H	I	J	K	L	N	O	Q	R	T	U	V	B	D	E	F	H	K	L
Bore/Shaft Dia. (in.)	1/4	5/16	3/8	1/2	1/2	5/8	5/8	3/4	7/8	1	1 1/8	1 1/4	1 3/8	1 1/2	5/8	7/8	1	1 1/8	1 1/4	1 1/2	1 5/8
Keyway (inches)	1/16 1/32	1/16 1/32	3/32 3/64	none	1/8 1/16	none	3/16 3/32	3/16 3/32	3/16 3/32	1/4 1/8	1/4 1/8	1/4 1/8	5/16 5/32	3/8 3/16	3/16 3/32	3/16 3/32	1/4 1/8	1/4 1/8	1/4 1/8	3/8 3/16	3/8 3/16

### Voltage Table

Character	Voltage
C	12 Vdc
E	24-28 Vdc
J	90-100 Vdc
N*	115 Vac*

\*Includes rectifier. Not available on sizes 3 and 8.

\*Special or metric bores available, consult factory.