

Super-Mod® Dimensional Data

[BACK TO SM PRODUCT OVERVIEW](#)

SM-1020, SM-1040, SM-20 and SM-20MB

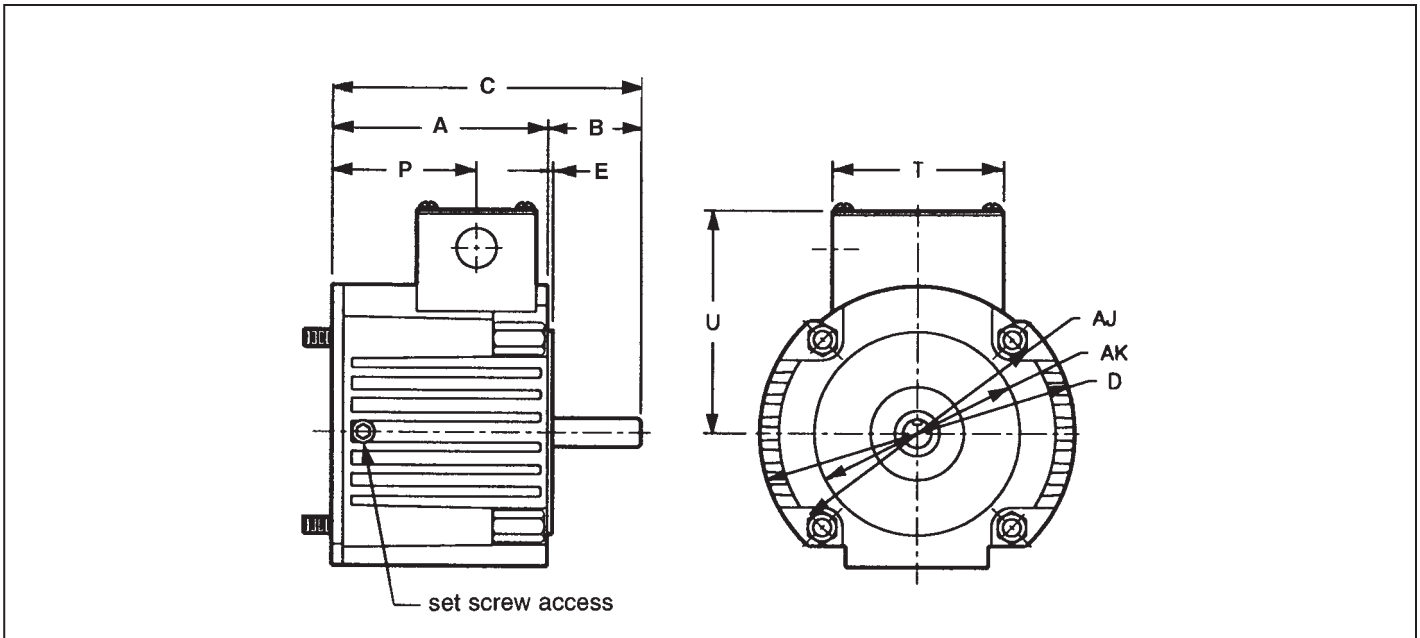

NEMA C-Face Frame Size	Configuration	Basic Module Style	Basic Model Number	AJ	AK	Hub bore and shaft ø	Keyway	A	B	C	D	E	P	T	U
SM-50 SM-100 48Y/56C 5/8 hub bore 5/8 shaft	C-face Clutch/Brake	1020	2-35-056X-0X-A*L	5.875	4.5	5/8	3/16 x 3/32	4.71	2.06	6.77	6.9	.16	3.15	2.8	4.9
	C-Face Clutch Only	1040	2-36-056X-0X-A*L					3.14		5.2			2.92		
	C-Face Brake Only	20	2-37-056X-0X-A*L					-	-	-					
	C-Face Brake Only without Shaft	20MB	2-37-056X-0X-X*L					-	-	-					
SM-180 182C/145TC 184C/145TC 7/8 hub bore 7/8 shaft	C-face Clutch/Brake	1020	2-35-140X-02-A*O	5.875	4.5	7/8	3/16 x 3/32	4.71	2.12	6.83	6.9	.16	3.15	3.8	4.9
	C-Face Clutch Only	1040	2-36-140X-02-A*O					3.14		5.25			1.58		
	C-Face Brake Only	20	2-37-140X-02-A*O					-	-	-					
	C-Face Brake Only without Shaft	20MB	2-37-140X-02-X*O					-	-	-					
SM-210 213C/182TC 215C/184TC 1-1/8 hub bore 1-1/8 shaft	C-face Clutch/Brake	1020	2-35-1801-03-A*R	7.25	8.5	1-1/8	1/4 x 1/8	6.11	2.59	8.7	9	.25	2.83	4	7.4
	C-Face Clutch Only	1040	2-36-1801-03-A*R					4.61		7.2			2.17		
	C-Face Brake Only	20	2-37-1801-03-A*R					-	-	-					
	C-Face Brake Only without Shaft	20MB	2-37-1801-03-X*R					-	-	-					
SM-250 254C/213TC 256C/215TC 1-3/8 hub bore 1-3/8 shaft	C-face Clutch/Brake	1020	2-35-2101-04-A*U	7.25	8.5	1-3/8	5/16 x 5/32	6.11	3.03	9.14	9	.25	2.83	4	7.4
	C-Face Clutch Only	1040	2-36-2101-04-A*U					4.61		7.64			2.17		
	C-Face Brake Only	20	2-37-2101-04-A*U					-	-	-					
	C-Face Brake Only without Shaft	20MB	2-37-2101-04-X*U					-	-	-					